

## MXG Series Modular Gourmet Ice Maker – up to 310kg

**MXG M 638 AS OX** Medium gourmet cube 20g, Ø30mm x 34mm



Medium gourmet cube  
20g, 30mm dia x H 34mm



Note: Ice production rate is measured with the water temperature at 10°C and an ambient temperature of 21°C.

- Up to 310kg daily production rate
- Head only ice maker - requires a separate storage bin to store the ice produced
- Air cooled version
- Produces individual transparent Gourmet crystal clear supercubes
- XSafe - Natural Sanitation System
- Horizontal evaporator spray-system technology
- Agion Technology resists the growth of microbes and the development of unpleasant odours
- Simple, reliable electronic controls
- Clean alert indicator to clean filter
- Resistant stainless steel exterior
- Simple, reliable electromechanic controls
- Easy access front condenser air filter
- External indicator lights to show operation status
- Includes removable air filter, water & drain hose

#### Recommended storage bins

- NB 393 – 178kg storage capacity
- NB 530 – 243kg storage capacity
- NB 948 with CBT 48 EAMCD cover – 406kg storage capacity



**XSafe**

### MXG Series Modular Gourmet Ice Maker – up to 310kg

#### MXG M 638 AS OX

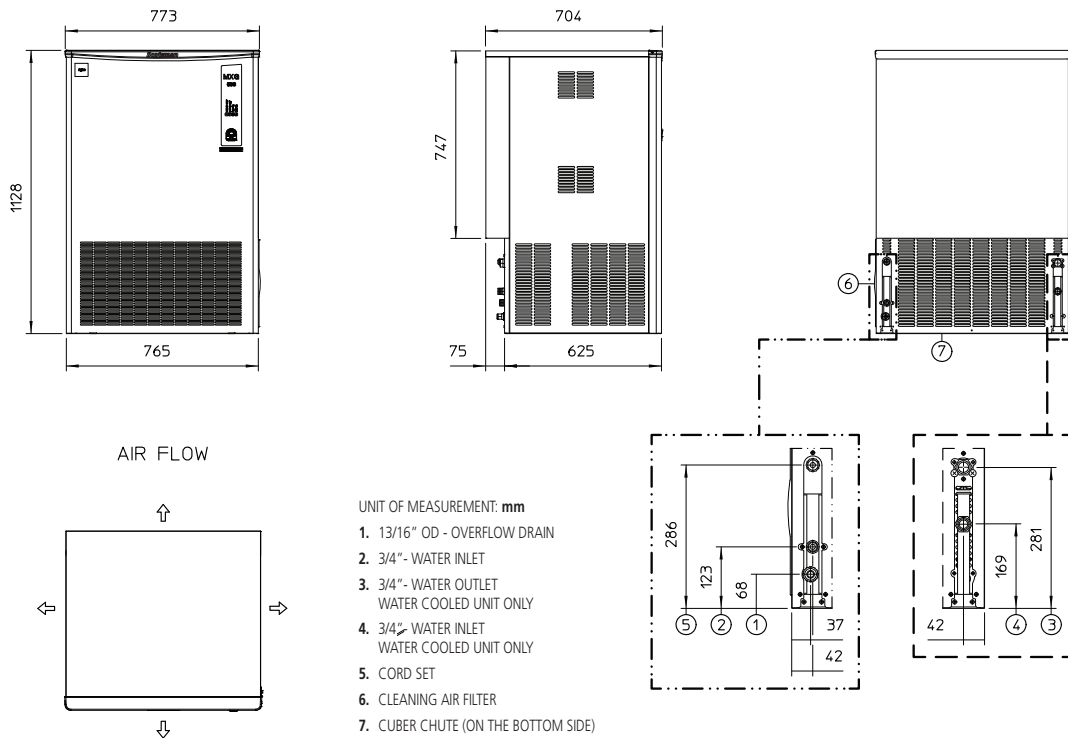

moffat.com.au

Australia  
Moffat Pty Limited  
Victoria/Tasmania  
740 Springvale Road  
Mulgrave, Victoria 3170  
Telephone 03-9518 3888  
Facsimile 03-9518 3833  
vsales@moffat.com.au

New South Wales  
Telephone 02-8833 4111  
nswsales@moffat.com.au

South Australia  
Telephone 03-9518 3888  
vsales@moffat.com.au

Queensland  
Telephone 07-3630 8600  
qldsales@moffat.com.au

Western Australia  
Telephone 08-9413 2400  
wasales@moffat.com.au

#### Ice production per 24 hours

Ambient temperature / Water temperature

10°C / 10°C	21°C / 10°C	32°C / 21°C
330	310	220

#### Dimensions

Width: 773mm  
Depth: 704mm  
Height: 1128mm  
Nett weight: 116kg  
Packed weight: 129kg

#### Water consumption

Air cooled version: 22.9 litres per hour

#### Electrical rating

Air cooled version: 230-240V, 1P+N+E, 50Hz, 2500W,  
10A cordset supplied

No. Circuit wire: 3  
Compressor: 7400W  
Energy consumption: 51kW/hr

#### Refrigerant type

R404a

#### Installation distance from wall

Rear 100mm  
Sides 150mm  
Operating requirement air temperature 10-43°C

#### Water connection requirements

Inlet connection: R 3/4"  
Cold water: 5-38°C  
Pressure: 100-500kPa  
Water outlet connection: Ø3/4"

#### Important Notice:

Models and specifications are subject to change without notice. This spec sheet is meant for commercial purpose only. For technical documentation please refer to our service manuals.



© Copyright Moffat Ltd  
AU.SM.2001